

### FEATURES

- Rating to 1000V PRV
- Surge overload rating to 150 Amperes peak
- Ideal for printed circuit board
- Reliable low cost construction utilizing molded plastic technique results in inexpensive product
- Lead solderable per MIL-STD-202 method 208

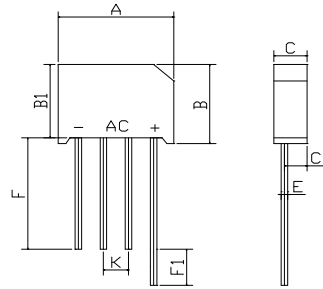

KBL		
Dim	Min	Max
A	18.85	19.25
B	15.70	16.10
B1	14.65	15.05
C	5.90	6.30
C1	3.95	4.25
E	Ø1.20	Ø1.40
F	19.00min	
F1	4.00min	
K	4.70	5.30
All Dimensions in mm		

### Maximum Ratings (@T<sub>A</sub> = 25°C unless otherwise specified)

Characteristic	Symbol	RS401L	RS 402L	RS403L	RS404L	RS405L	RS406L	RS407L	UNITS
Maximum recurrent peak reverse voltage	V <sub>RRM</sub>	50	100	200	400	600	800	1000	V
Maximum RMS voltage	V <sub>RMS</sub>	35	70	140	280	420	560	700	V
Maximum DC blocking voltage	V <sub>DC</sub>	50	100	200	400	600	800	1000	V
Maximum average forward Output current @T <sub>A</sub> =25°C	I <sub>F(AV)</sub>	4.0							A
Peak forward surge current 8.3ms single half-sine-wave superimposed on rated load	I <sub>FSM</sub>	150							A
I <sup>2</sup> t Rating for fusing @T <sub>j</sub> =25°C	I <sup>2</sup> t	93							A <sup>2</sup> S
Typical Junction Capacitance	C <sub>J</sub>	40							pF

### Thermal Characteristics

Characteristic	Symbol	RS401L	RS 402L	RS403L	RS404L	RS405L	RS406L	RS407L	UNITS
Typical thermal resistance per leg	R <sub>θJA</sub>	28							°C/W
	R <sub>θJC</sub>	10							
Operating junction temperature range	T <sub>J</sub>	- 55 ---- + 150							°C
Storage temperature range	T <sub>STG</sub>	- 55 ---- + 150							°C

### Electrical Characteristics (@T<sub>A</sub> = 25°C unless otherwise specified)

Characteristic	Symbol	RS401L	RS 402L	RS403L	RS404L	RS405L	RS406L	RS407L	UNITS
Maximum instantaneous forward voltage @2.0A	V <sub>F</sub>	1.1							V
Maximum reverse current @T <sub>A</sub> =25°C at rated DC blocking voltage @T <sub>A</sub> =100°C	I <sub>R</sub>	5.0							µA
		1.0							A



**FIG.1 – TYPICAL FORWARD CURRENT DERATING CURVE**

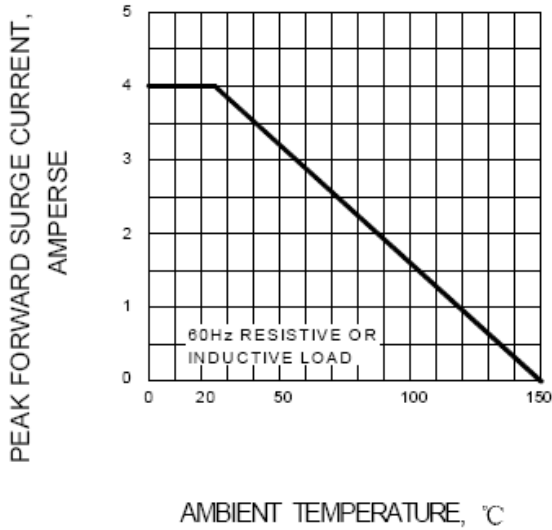

**FIG.2 – MAXIMUM FORWARD SURGE CURRENT**

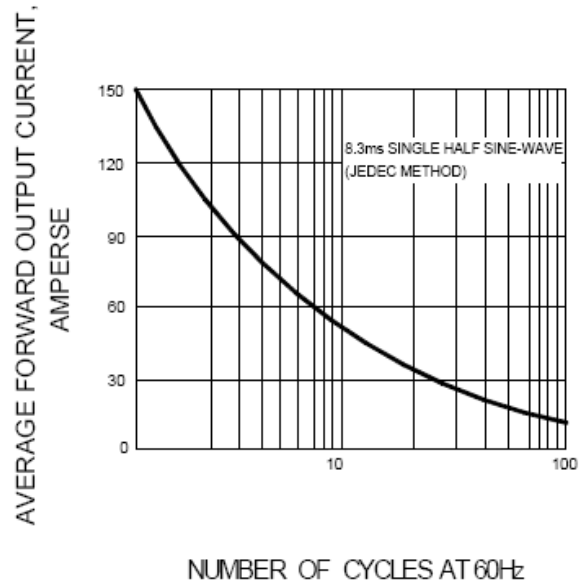

**FIG.3 – TYPICAL FORWARD CHARACTERISTIC**

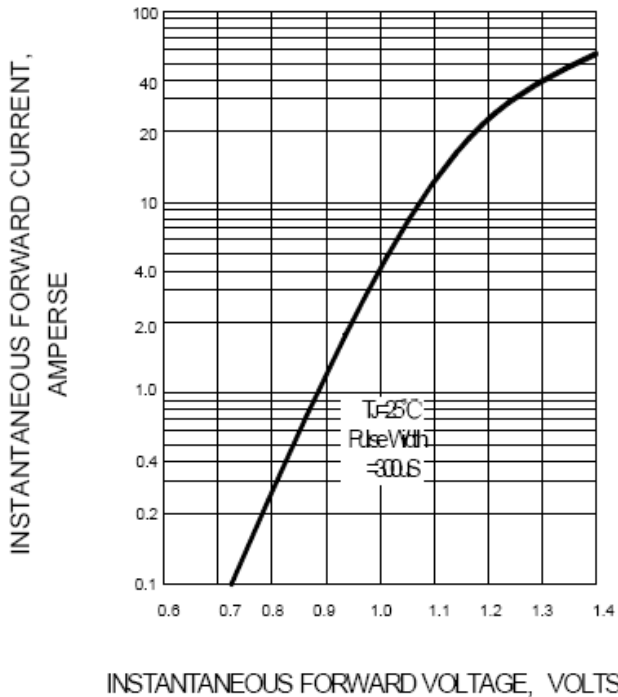

**FIG.4 – TYPICAL REVERSE CHARACTERISTIC**

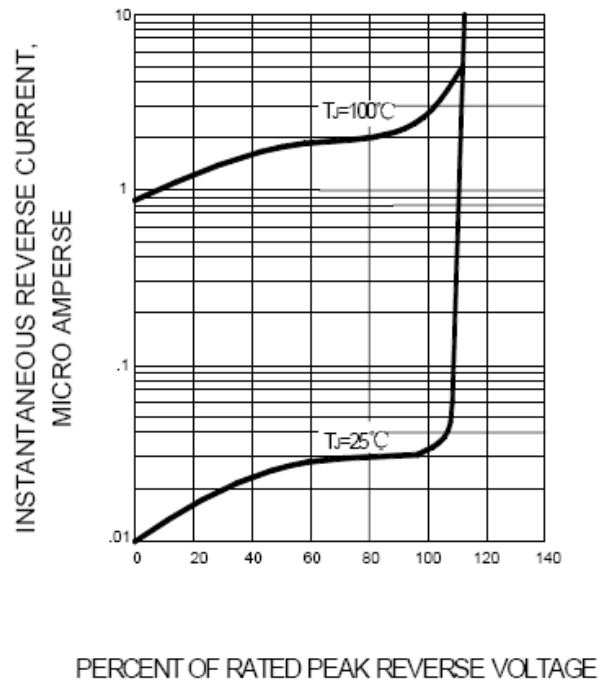

Device	Package	Shipping
RS401L--RS407L	KBL	500 Units/Box