

FEATURES

- Rating to 1000V PRV
- Surge overload rating to 135 Amperes peak
- Reliable low cost construction utilizing molded plastic technique results in inexpensive product
- Lead solderable per MIL-STD-202 method 208

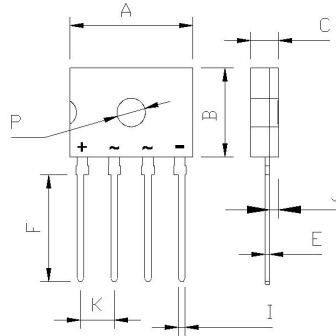

D3K		
Dim	Min	Max
A	13.65	14.15
B	9.80	10.20
C	2.95	3.25
E	0.35	0.65
F	11.70	12.30
I	0.65	0.95
J	0.90	1.20
K	3.60	4.00
P	Ø3.2Typical	
All Dimensions in mm		

Maximum Ratings (@TA = 25°C unless otherwise specified)

Characteristic	Symbol	LGE 4005	LGE 401	LGE 402	LGE 404	LGE 406	LGE 408	LGE 410	UNITS
Maximum recurrent peak reverse voltage	V _{RRM}	50	100	200	400	600	800	1000	V
Maximum RMS voltage	V _{RMS}	35	70	140	280	420	560	700	V
Maximum DC blocking voltage	V _{DC}	50	100	200	400	600	800	1000	V
50Hz sine wave, R-load Without heat sink Ta=25°C	I _{F(AV)}	4.0							A
Peak forward surge current 8.3ms single half-sine-wave superimposed on rated load	I _{FSM}	135							A
I ² t Rating for fusing @Tj=25°C	I ² t	75.6							A ² S

Thermal Characteristics

Characteristic	Symbol	Value	UNITS
Typical Thermal Resistance (Note)	R _{θJA}	14	°C/W
	R _{θJC}	8.2	
	R _{θJL}	9.3	
Operating junction temperature range	T _J	- 55 ---- + 150	°C
Storage temperature range	T _{STG}	- 55 ---- + 150	°C

Electrical Characteristics (@TA = 25°C unless otherwise specified)

Characteristic	Symbol	Value	UNITS
Maximum instantaneous forward voltage @2.0A	V _F	1.0	V
Maximum reverse current at rated DC blocking voltage	I _R	@T _A =25 °C	5.0
		@T _A =100°C	500
			μ A

RATINGS AND CHARACTERISTICS CURVES

($T_A = 25^\circ\text{C}$ unless otherwise noted)

Fig.1 Maximum Derating Curve For Output current

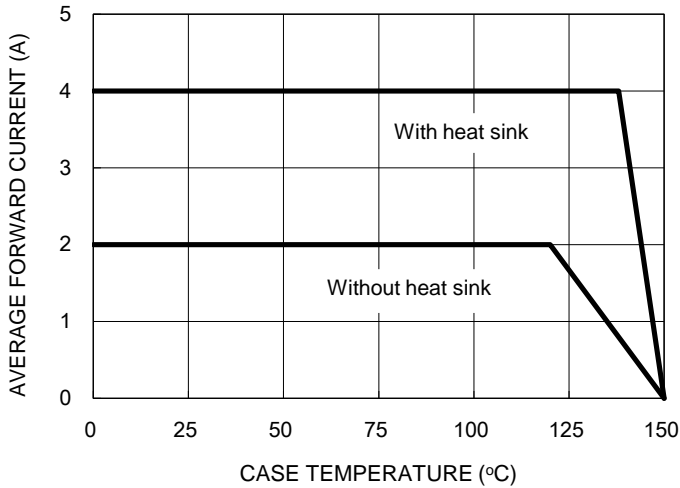

Fig.2 Maximum Forward Surge Current

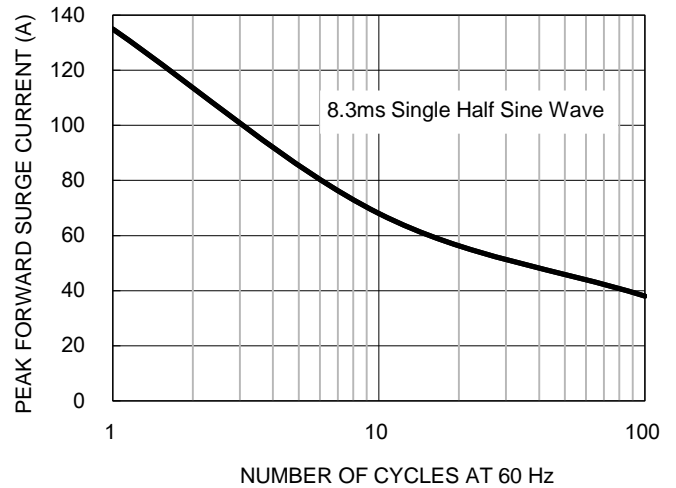

Fig.3 Typical Reverse Characteristics

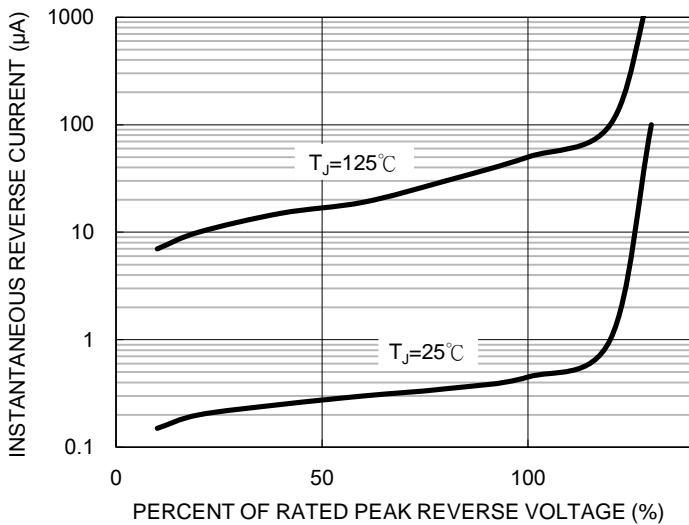
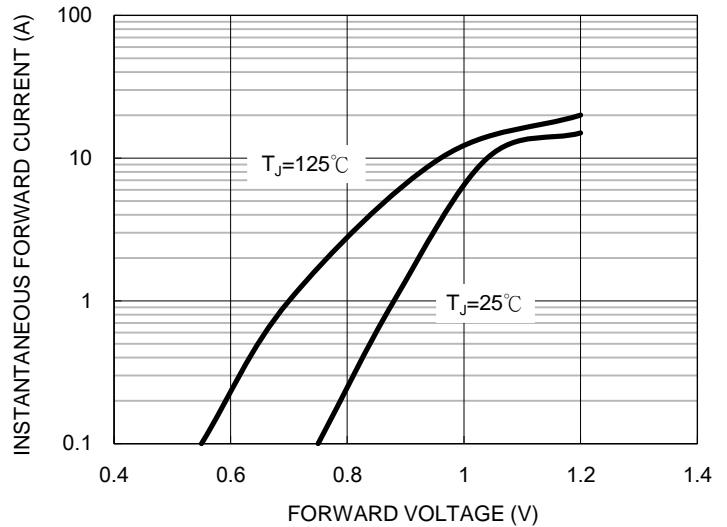

Fig.4 Typical Forward Characteristics



Package	Tube (mm)	Q'TY/Tube (Kpcs)	Box Size (mm)	QTY/Box (Kpcs)	Carton Size (mm)	Q'TY/Carton (Kpcs)
D3K	445*30.7*5.6	0.03	495*130*70	1.2	520*370*155	6